



HARDIN COUNTY
Board of Supervisors

Wednesday, October 14, 2020

NOTICE: Public attendance at public meetings is restricted due to COVID-19 concerns. To access and participate in meetings remotely, please call 641-939-8108 for meeting information.

1. 9:00 A.M. Call To Order
Courthouse Large Conference Room
2. Pledge Of Allegiance
3. Approval Of Agenda
4. Approval Of Claims For Payment

Documents:

[VENDOR PUBLICATION REPORT.PDF](#)

5. Utility Permits & Secondary Roads Department

Documents:

[IRUA PERMIT 20-034.PDF](#)

6. Approve Final Plans For HMA Resurfacing Project STBG-SWAP-CO42(107)—FG-42 On County Highway D55
7. Set Time And Date For Budget Amendment FY 2020-2021
8. Tax Abate Orders

Documents:

[TAX ABATE ORDERS 5915-5916.PDF](#)

9. Estimate For Home Farm Tile And Erosion Investigation

Documents:

[HARDIN CO HOME FARM ESTIMATE.PDF](#)

10. Auditor's Monthly Report

Documents:

[AUDITORS REPORT OF FEES COLLECTED.PDF](#)

11. Recorder's Monthly Report

Documents:

[RECORDERS MONTHLY REPORT.PDF](#)

12. Sheriff's Monthly Report

Documents:

[SHERIFFS MONTHLY REPORT.PDF](#)

13. Flex Benefits Renewal

14. Change Of Status – Auditor's Office

15. Motion To Amend Courthouse Entry Policy

Documents:

[ENTRY POLICY MODIFIED 10-8-2020.PDF](#)

16. Emergency Management Update

17. Public Comments

18. Other Business

19. Manure Application Policy And Logistical Considerations (Discussion Only)

20. Adjournment/Recess

21. 9:30 A.M. Drainage
Courthouse Large Conference Room



Hardin County

Vendor Publication Report

Payment Date Range: 10/14/2020 - 10/14/2020

Vendor Name	Vendor Number	Total Payments
Ackley Public Library	648V	761.11
Ahlers & Cooney-P.C.	61244V	1,700.00
Airgas North Central	633V	369.56
Alden Public Library	649V	1,522.22
Alliant Energy	4253V	2,041.23
Bonnie Wiederkehr	2485V	153.60
Campbell Supply Co	620V	1,399.73
Center Associates	883V	301.00
Central Iowa Distr Inc	3043V	2,507.20
Chelsey Lewer	100352	273.00
Cintas Corporation	1545V	69.11
City of Alden	512V	0.21
City of Eldora	510V	5,799.11
City of Iowa Falls	509V	1,522.22
City of Radcliffe	517V	69.61
Clapsaddle-Garber Assoc	62302V	3,842.35
Concrete Inc	3067V	12,470.87
Connection	100698	1,751.41
Connie J Mesch	1020E	50.00
Cooley Pumping LLC	61963V	575.00
Culligan	857V	322.80
Donald C Orgel	116E	105.00
Don's Truck Sales Inc	5632V	62.56
Eichmeier Motor Co	100382	875.33
Eldora Hardware	2647V	70.81
ElectionSource	2425V	103.31
Eric Eugenio	100207	778.00
Fareway Stores	717V	311.82
Fastenal	2247V	2.55
Gehrke Quarries, Inc.	145V	1,495.68
Greenbelt Home Care	61807V	12,557.69
Grundy Co. Memorial Hospital	62473V	742.00
Hardin Co Agriculture Soc	545V	2,000.00
Hardin Co Solid Waste & Recycling	4322V	30.00
Hardin Co Tire & Service Inc	4240V	454.32
Hardin County Sheriff	1452V	9,166.66
Heart of Iowa	6335V	761.26
Helms & Associates, LLC	100660	24,000.00
Heritage Motors LLC	100500	39.49
Homestead Evergreens	6072V	234.00
Hubbard Public Library	651V	1,522.22
IFADC	62574V	8,250.00
Innovative Ag Services	868V	854.81
Iowa Department of Natural Resources	100262	95.00
Iowa Plains Signing, Inc.	63912V	2,504.00
Linn Adams	9245E	40.00
Marla Kay Williams	2268V	259.50
Martin Marietta Aggregate	4141V	4,623.48
Mary J Swartz	302E	142.03
McDowell & Sons Contractors	81064D	330.00
Mend Correctional Care PLLC	2724V	10,625.87
Mid-America Publishing Corp	62056V	567.66
NAPA Auto Parts	4290V	52.72
Premier Office Equipment	62320V	119.79
Public Employee Health Fund	1782V	1,563.67

Vendor Publication Report**Payment Date Range: 10/14/2020 - 10/14/2020**

Vendor Name	Vendor Number	Total Payments
Quaker Security LLC	100507	2,550.00
R Comm Wireless	63277V	510.00
Radcliffe Public Library	653V	1,522.22
Ricoh USA Inc	2864V	8.63
River City Fence	100699	2,850.00
Schumacher Elevator Co.	2130V	509.63
Shield Pest Control	63086V	124.00
Society of Land Surveyors IA	2433V	15.00
South Fork Custom Fencing, LLC	100700	4,169.00
Speck Electric	63534V	478.45
Stanard & Associates Inc.	61501V	43.00
Steamboat Rock Library	654V	1,522.22
Steven G Recker	219E	106.00
Storey Kenworthy	61798V	9,693.38
Summit Food Service LLC	2332V	4,494.56
Surls Funeral Home	567V	1,975.00
Terracon	2688V	975.00
Times Citizen	538V	530.10
Tom Wilkerson	100696	1,200.00
Union Auto Inc.	1523V	245.45
Union Public Library	655V	1,522.22
US Bank Equipment Finance	954V	2,908.11
Veridian Credit Union	63561V	1,469.21
Wayne Carpenter	100701	40.00
Windstream Communications	62349V	327.50
Grand Total:	162,631.25	

Lance Granzow, Chair
Board of Supervisors

Jessica Lara
Hardin County Auditor



HARDIN COUNTY UTILITY PERMIT APPLICATION

Permit No: _____

Underground
 Aerial

Permanent Installation
 Temporary Installation

This is a Utility Permit Application for telecommunications, electric, gas, water and sewer utilities. The applicant agrees to comply with the following permit requirements. Compliance shall be determined by the sole discretion of the County Engineer as deemed necessary to promote public health, safety, and general welfare. These requirements shall apply unless waived in writing by the County Engineer prior to installation.

APPLICANT NAME: _____

STREET ADDRESS: _____

CITY: _____ STATE: _____ ZIP: _____

PHONE: _____ FAX: _____ CONTACT PERSON: _____

TYPE OF WORK: _____

1. LOCATION PLAN

An applicant shall file a completed location plan as an attachment to this Utility Permit Application. The location plan shall set forth the location of the proposed line on the secondary road system and include a description of the proposed installation.

2. WRITTEN NOTICE

At least five (5) working days prior to the proposed installation, an applicant shall file with the County Engineer a written notice stating the time, date, location, and nature of the proposed installation.

3. INSPECTION

The County Engineer may provide a full-time inspector during the installation of all lines to ensure compliance with this Utility Permit. The inspector shall have the right, during reasonable hours and after showing proper identification, to enter any installation site in the discharge of the inspector's official duties, and to make any inspection or test that is reasonably necessary to protect the public health, safety, and welfare.

4. INSPECTION FEES

The applicant shall pay actual costs directly attributable to the installation inspection conducted by the County Engineer. Within thirty (30) days after completion of the installation, the County Engineer shall submit a statement for inspection services rendered. The applicant agrees to reimburse the county within thirty (30) days of billing.

5. REQUIREMENTS

The installation inspector shall assure that the following requirements have been met:

- A. Construction signing shall comply with the Manual on Uniform Traffic Control Devices
- B. Depth – (Add additional depth if ditch has silted to the thickness of the deposited silt.) The minimum depth of cover shall be as follows:

Telecommunications....	36"	Electric.....	48"
Gas.....	48"	Water.....	60"
Sewer.....	60"		
- C. Minimum roadway overhead clearance for utility lines shall be 20 feet.
- D. The applicant shall use reference markers in the right-of-way (ROW) boundary to locate line and changes in alignment as required by the County Engineer. A permanent warning tape shall be placed one (1) foot above all underground utility lines.
- E. All tile line locations shall be marked with references located in the ROW line.
- F. No underground utility lines shall cross over a crossroad drainage structure without approval from the County Engineer.
- G. Residents along the utility route shall have uninterrupted access to the public roads. An all weather access shall be maintained for residents adjacent to the project.
- H. After construction, granular surfacing shall be added to the road by the applicant to restore the road to its original condition. After surfacing has been applied, the road surface shall be reviewed by the County Engineer once the road has been saturated, to determine if additional surfacing on the roadway by the applicant is necessary.
- I. All damaged areas within the ROW shall be repaired and restored to at least their former condition by the applicant or the cost of any repair work caused to be performed by the county will be assessed against the applicant.
- J. Areas disturbed during construction which present an erosion problem shall be solved by the applicant in a manner approved by the County Engineer.
- K. All trenches, excavations, and utilities that are knifed shall be properly tamped.
- L. All utilities shall be located between the bottom of the backslope and the bottom of the foreslope, unless otherwise approved in writing by the County Engineer prior to installation.
- M. Road crossing shall be bored. The depth below the road surface shall match the minimum depth of cover for the respective utility.

6. NON-CONFORMING WORK

The County Engineer may halt the installation at any time if the applicant's work does not meet the requirements set forth in this Utility Permit Application.

7. COUNTY INFRACTION

Violation of this permit is a county infraction under Iowa Code Section 331.307, punishable by a civil penalty of \$100 for each violation. Each day that a violation occurs or is permitted to exist by the applicant constitutes a separate offense.

8. HOLD HARMLESS

The utility company shall save this county harmless of any damages resulting from the applicant's operations. A copy of a certificate of insurance naming this county as an additional insured for the permit work shall be filed in the County Engineer's Office prior to installation. The minimum limits of liability under the insurance policy shall be \$1,000,000.

9. PERMIT REQUIRED

No applicant shall install any lines unless such applicant has obtained a Utility Permit from the County Engineer and has agreed in writing that said installation will comply with all ordinances and requirements of the county for such work. Applicants agree to hold the county free from liability for all damage to applicant's property which occurs proximately as a result of the applicant's failure to comply with said ordinances or requirements.

10. RELOCATION

The applicant shall, at any time subsequent to installation of utility lines, at the applicant's own expense, relocate or remove such lines as may become necessary to conform to new grades, alignment or widening of ROW resulting from maintenance or construction operations for highway improvements.

DATE: _____ COMPANY: _____

SIGNATURE: Filled out online _____

RECOMMENDED FOR APPROVAL:

DATE: _____ COUNTY ENGINEER _____

APPROVAL:

DATE: _____ CHAIRMAN, BOARD OF SUPERVISORS _____

NON-BORED INSTALLATION DETAIL

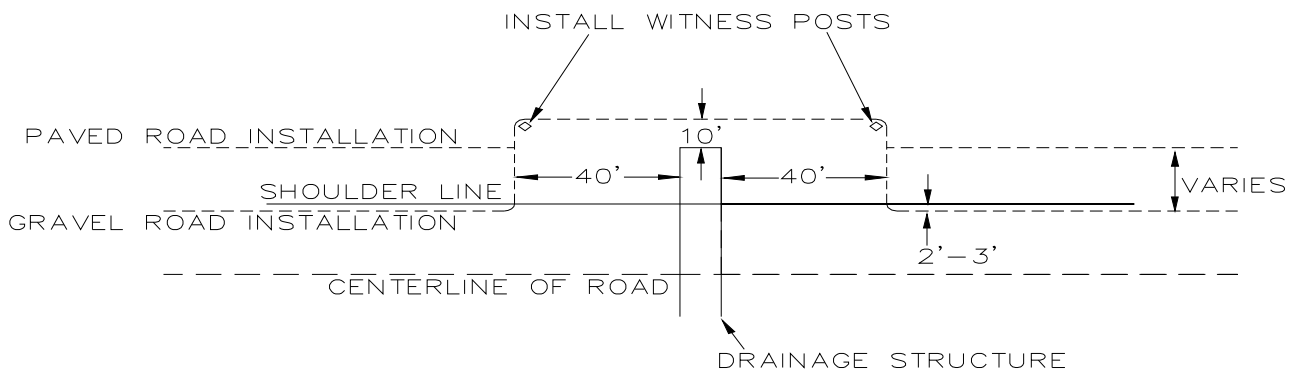

BORED INSTALLATION DETAIL

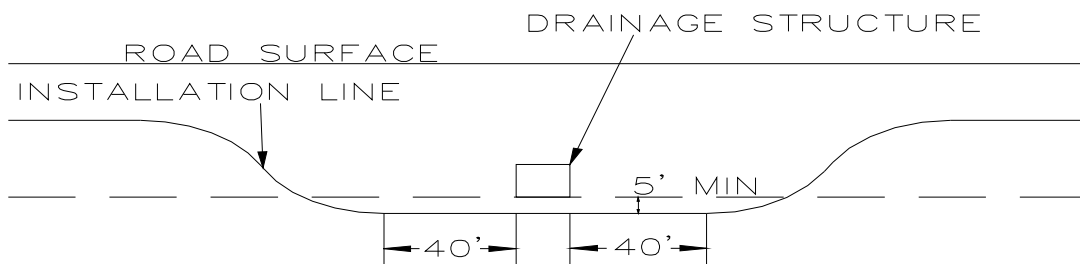



HARDIN COUNTY

IOWA REGIONAL UTILITIES ASSOCIATION
1351 IOWA SPEEDWAY DRIVE, NEWTON, IOWA 50208-8254
(641) 792-7011

DRAWN BY
GJK
4/5/2018

THIS MAP IS
BASED ON
IOWA DOT
HIGHWAY
MAPS
SHEET
L-42
PARTIAL

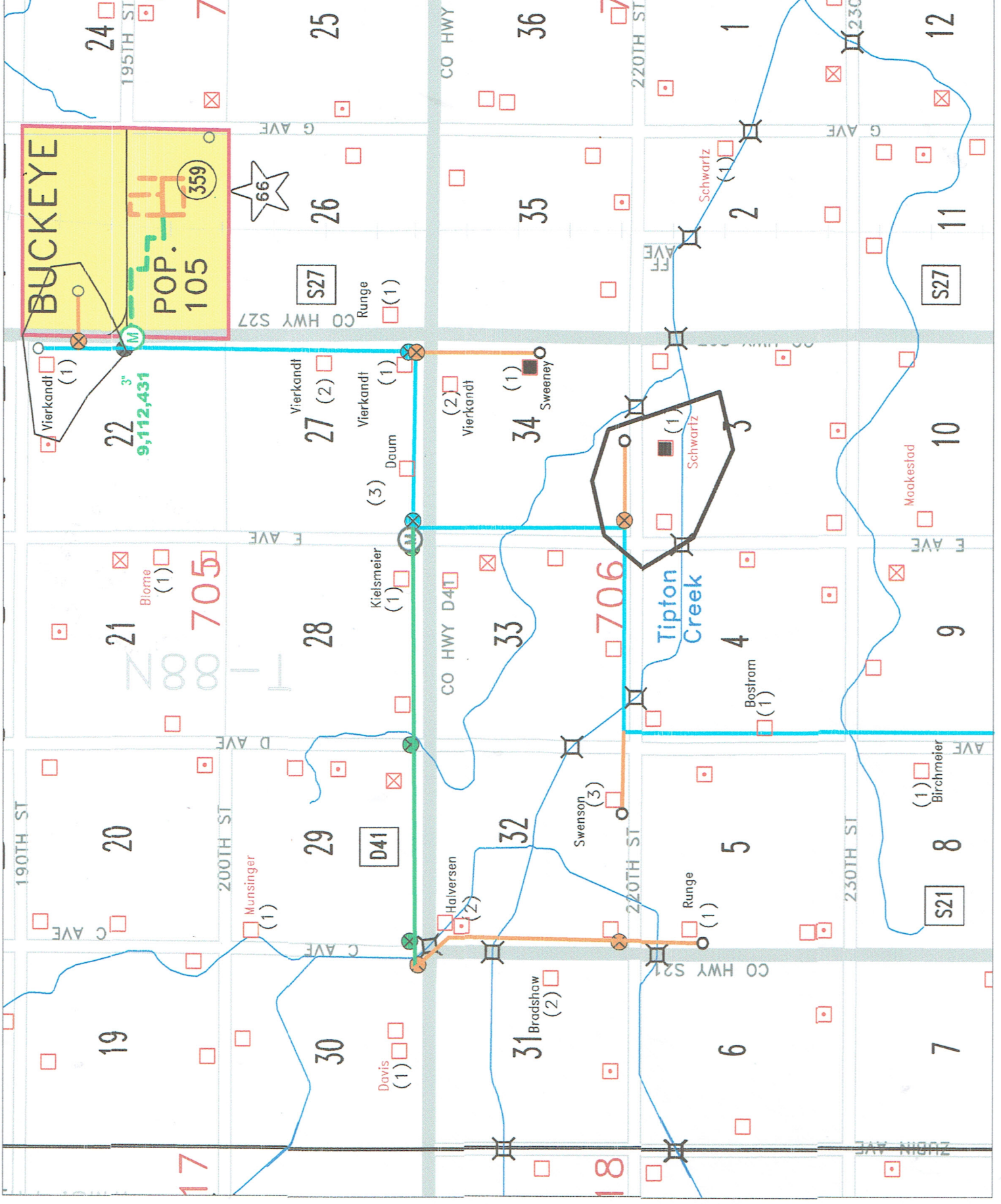

BUCKEYE

POP. 105

359

9,112,431

3"

M

705

706

Tipton Creek

195TH ST

200TH ST

220TH ST

230TH ST

190TH ST

200TH ST

220TH ST

230TH ST

20

29

32

5

19

30

31

6

21

28

33

4

26

35

2

25

36

1

12

11

10

9

8

7

CO HWY S27

CO HWY

CO HWY S27

CO HWY D41

CO HWY S21

E AVE

D AVE

C AVE

G AVE

E AVE

AVE

ZUBIN AVE

Runge (1)

Vierkandt (2)

Vierkandt (1)

Daum (3)

Kielsmeier (1)

Vierkandt (2)

Sweeney (1)

Schwartz (1)

Schwartz (1)

Swenson (3)

Runge (1)

Bradshaw (2)

Halvorsen (2)

Munsinger (1)

Davis (1)

Blome (1)

Bosstrom (1)

Birchmeier (1)

Mookeslad

Schwartz (1)

Schwartz (1)

Schwartz (1)

Schwartz (1)

Schwartz (1)

Schwartz (1)

Schwartz (1)

Schwartz (1)

Schwartz (1)

Schwartz (1)

Schwartz (1)

Schwartz (1)

Schwartz (1)

Schwartz (1)

Schwartz (1)

Schwartz (1)

Schwartz (1)

Schwartz (1)

Schwartz (1)

Schwartz (1)

Schwartz (1)

Schwartz (1)

Schwartz (1)

Schwartz (1)

Schwartz (1)

Schwartz (1)

Schwartz (1)

Schwartz (1)

Schwartz (1)

Schwartz (1)

Schwartz (1)

Schwartz (1)

Schwartz (1)

Schwartz (1)

Schwartz (1)

Schwartz (1)

Schwartz (1)

Schwartz (1)

Schwartz (1)

Schwartz (1)

Schwartz (1)

Schwartz (1)

Schwartz (1)

Schwartz (1)

Schwartz (1)

Schwartz (1)

Schwartz (1)

Schwartz (1)

Schwartz (1)

Schwartz (1)

Schwartz (1)

Schwartz (1)

Schwartz (1)

Schwartz (1)

Schwartz (1)

Schwartz (1)

Schwartz (1)

Schwartz (1)

Schwartz (1)

Schwartz (1)

Schwartz (1)

Schwartz (1)

Schwartz (1)

Schwartz (1)

Schwartz (1)

Schwartz (1)

Schwartz (1)

Schwartz (1)

Schwartz (1)

Schwartz (1)

Schwartz (1)

Schwartz (1)

Schwartz (1)

Schwartz (1)

Schwartz (1)

Schwartz (1)

Schwartz (1)

Schwartz (1)

Schwartz (1)

Schwartz (1)

Schwartz (1)

Schwartz (1)

Schwartz (1)

Schwartz (1)

Schwartz (1)

Schwartz (1)

Schwartz (1)

Schwartz (1)

Schwartz (1)

Schwartz (1)

Schwartz (1)

Schwartz (1)

Schwartz (1)

Schwartz (1)

Schwartz (1)

Schwartz (1)

Schwartz (1)

Schwartz (1)

Schwartz (1)

Schwartz (1)

Schwartz (1)

Schwartz (1)

Schwartz (1)

Schwartz (1)

Schwartz (1)

Schwartz (1)

Schwartz (1)

Schwartz (1)

Schwartz (1)

Schwartz (1)

Schwartz (1)

Schwartz (1)

Schwartz (1)

Schwartz (1)

Schwartz (1)

Schwartz (1)

Schwartz (1)

Schwartz (1)

Schwartz (1)

Schwartz (1)

Schwartz (1)

Schwartz (1)

Schwartz (1)

Schwartz (1)

Schwartz (1)

Schwartz (1)

Schwartz (1)

Schwartz (1)

Schwartz (1)

Schwartz (1)

Schwartz (1)

Schwartz (1)

Schwartz (1)

Schwartz (1)

Schwartz (1)

Schwartz (1)

Schwartz (1)

Schwartz (1)

Schwartz (1)

Schwartz (1)

Schwartz (1)

Schwartz (1)

Schwartz (1)

Schwartz (1)

Schwartz (1)

Schwartz (1)

Schwartz (1)

Schwartz (1)

Schwartz (1)

Schwartz (1)

Schwartz (1)

Schwartz (1)

Schwartz (1)

Schwartz (1)

Schwartz (1)

Schwartz (1)

Schwartz (1)

Schwartz (1)

Schwartz (1)

Schwartz (1)

Schwartz (1)

Schwartz (1)

Schwartz (1)

Schwartz (1)

Schwartz (1)

Schwartz (1)

Schwartz (1)

Schwartz (1)

Schwartz (1)

Schwartz (1)

Schwartz (1)

Schwartz (1)

Schwartz (1)

Schwartz (1)

Schwartz (1)

Schwartz (1)

Schwartz (1)

Schwartz (1)

Schwartz (1)

Schwartz (1)

Schwartz (1)

Schwartz (1)

Schwartz (1)

Schwartz (1)

Schwartz (1)

Schwartz (1)

Schwartz (1)

Schwartz (1)

Schwartz (1)

Schwartz (1)

Schwartz (1)

Schwartz (1)

Schwartz (1)

Schwartz (1)

Schwartz (1)

Schwartz (1)

Schwartz (1)

Schwartz (1)

Schwartz (1)

Schwartz (1)

Schwartz (1)

Schwartz (1)

Schwartz (1)

Schwartz (1)

Schwartz (1)

Schwartz (1)

Schwartz (1)

Schwartz (1)

Schwartz (1)

Schwartz (1)

Schwartz (1)

Schwartz (1)

Schwartz (1)

Schwartz (1)

Schwartz (1)

Schwartz (1)

Schwartz (1)

Schwartz (1)

Schwartz (1)

Schwartz (1)

Schwartz (1)

Schwartz (1)

Schwartz (1)

Schwartz (1)

Schwartz (1)

Schwartz (1)

Schwartz (1)

Schwartz (1)

Schwartz (1)

Schwartz (1)

Schwartz (1)

Schwartz (1)

Schwartz (1)





HARDIN COUNTY

Auditor's Office

Order # 5915

Date: 10/9/2020

To the Treasurer of Hardin County Iowa:

You are hereby authorized to: Abate the 2019 taxes of:
(Add/Abate/Suspend)

Brown, Paul & Andrea 500 Providence Twp Eldora-New Provi
 Owner's Name Tax District
86-20-04-300-001 NW SW
 Parcel Number Property Description

Credits	Military Values	Homestead Credit	Ag Land Credit	Family Farm Credit	Elderly Credit	BPTC Credit
Gross Value	-	-	2.42	2.42	-	-
% Funded			20.2286	14.1918		
Net	-	-	49.03	34.40	-	-

Class A Levy Rate 0.02769412 Rollback 81.4832%

VALUES

Old Bldg Value	\$ -	New 100% Bldg Value	\$ -	New Taxable Bldg	\$ -
Old Land Value	\$ 58,080	New 100% Land Value	\$ 58,080	New Taxable Land	\$ 47,325
Old Dwelling	\$ -	New 100% Dwelling	\$ -	New Taxable Dwell	\$ -
Military Credit					\$ -
Total Old Value	\$ 58,080	Total New Value	\$ 58,080	Total New Taxable	\$ 47,325

TAX AMOUNTS

Old Tax Amount	\$ 1,262.00	Less Amount Paid	\$ 631.00		
New Gross Tax	\$ 1,310.64	Less Credits	\$ 83.43	New Net Tax	\$ 1,228

Reason For Change FF credit wasn't applied

Amount Due \$ (597.00) Tax Receipt # 195712
 Net change \$ 48.64

 Jessica Lara, Auditor

Board of Supervisors Chairman

Machel Eichmeier
Hardin County Treasurer
 P.O. Box 391
 Eldora, IA 50627
 meichmeier@hardincountyia.gov

Receipt#
195712
 Parcel #
 000862004300001

Machel Eichmeier
Hardin County Treasurer
 P.O. Box 391
 Eldora, IA 50627
 meichmeier@hardincountyia.gov

Receipt#
195712
 Parcel #
 000862004300001

TOTAL TAX DUE: or **Sept 1, 2020**
\$1228.00 **\$631.00**
 004472000 Delinquent: Oct 1, 2020

TAX DUE: **March 1, 2021**
\$597.00
 004472000 Delinquent: April 1, 2021

BROWN, PAUL & ANDREA
 1611 West Lakes Pkwy
 West Des Moines, IA 50266

BROWN, PAUL & ANDREA
 1611 West Lakes Pkwy
 West Des Moines, IA 50266

500 Providence Twp Eldora-New Providence

500 Providence Twp Eldora-New Providence

Hardin County Tax Bill for September 2020 and March 2021. Please keep in a safe place. Send the correct stubs along with your check for payment. If your taxes are paid by your Bank in Escrow, this is for your information only. SEE REVERSE SIDE. Based on January 1, 2019 Valuations. Taxes cover the period from July 1, 2019 to June 30, 2020. Payable September 2020 and March 2021.

Parcel #: 000862004300001

Location:

500 Providence Twp Eldora-New Providence

Gross Acres -
 Exempt Acres -
 Net Acres -

LEGAL Description: NW SW

VALUATIONS AND TAXES THIS YEAR			LAST YEAR		TAX DUE	Delinquent Tax, Specials, Drainage, Tax Sale
A	Assessed	Taxable	Assessed	Taxable		
Land:	58,080	47,325	84,180	47,252		
Buildings:	-	-	-	-		
Dwelling:	-	-	-	-		
TOTAL VALUE:	58,080	47,325	84,180	47,252		
Less Military Exemption:						
NET TAXABLE VALUE:		\$47,325		\$47,252		
Value Times Levy per 1000 of:	27.6941200		26.3684400		004472000	
EQUALS GROSS TAX OF:		1,310.62		1,245.96		
Less Credits of:						
Homestead Credit:					BROWN, PAUL & ANDREA	
Ag Land Credit:		-49.03			1611 West Lakes Pkwy	
Family Farm Credit:		-34.40			West Des Moines, IA 50266	
Business Prop Tax Credit Fund:						
Low Income/Elderly Credit:						
Prepaid Tax:						
NET ANNUAL TAXES:		\$1,228.00		\$1,246.00		

YOU MAY PAY ONLINE AT: WWW.IOWATREASURERS.ORG

Machel Eichmeier
Hardin County Treasurer
 P.O. Box 391
 Eldora, IA 50627
 meichmeier@hardincountyia.gov

Receipt#
195712

DUE Sept. 1, 2020

\$631.00

DUE March 1, 2021

\$597.00

Date Paid: _____

Date Paid: _____

CHECK# _____

CHECK# _____



HARDIN COUNTY

Auditor's Office

Order # 5916

Date: 10/9/2020

To the Treasurer of Hardin County Iowa:

You are hereby authorized to: Abate the 2019 taxes of:
(Add/Abate/Suspend)

Brown, Paul & Andrea 500 Providence Twp Eldora-New Provi
 Owner's Name Tax District
86-20-05-400-002 NE SE
 Parcel Number Property Description

Credits	Military Values	Homestead Credit	Ag Land Credit	Family Farm Credit	Elderly Credit	BPTC Credit
Gross Value	-	-	2.43	2.43	-	-
% Funded			20.2286	14.1918		
Net	-	-	49.17	34.49	-	-

Class A Levy Rate 0.02769412 Rollback 81.4832%

VALUES

Old Bldg Value	\$ -	New 100% Bldg Value	\$ -	New Taxable Bldg	\$ -
Old Land Value	\$ 58,250	New 100% Land Value	\$ 58,250	New Taxable Land	\$ 47,464
Old Dwelling	\$ -	New 100% Dwelling	\$ -	New Taxable Dwell	\$ -
Military Credit					\$ -
Total Old Value	\$ 58,250	Total New Value	\$ 58,250	Total New Taxable	\$ 47,464

TAX AMOUNTS

Old Tax Amount	\$ 1,266.00	Less Amount Paid	\$ 633.00		
New Gross Tax	\$ 1,314.47	Less Credits	\$ 83.66	New Net Tax	\$ 1,230

Reason For Change FF credit wasn't applied

Amount Due \$ (597.00) Tax Receipt # 195737
 Net change \$ 48.47

 Jessica Lara, Auditor

Board of Supervisors Chairman

Machel Eichmeier
Hardin County Treasurer
 P.O. Box 391
 Eldora, IA 50627
 meichmeier@hardincountyia.gov

Receipt#
195737
 Parcel #
 000862005400002

Machel Eichmeier
Hardin County Treasurer
 P.O. Box 391
 Eldora, IA 50627
 meichmeier@hardincountyia.gov

Receipt#
195737
 Parcel #
 000862005400002

TOTAL TAX DUE: or **Sept 1, 2020**
\$1230.00 **\$633.00**
 004472000 Delinquent: Oct 1, 2020

TAX DUE: **March 1, 2021**
\$597.00
 004472000 Delinquent: April 1, 2021

BROWN, PAUL & ANDREA
 1611 West Lakes Pkwy
 West Des Moines, IA 50266

BROWN, PAUL & ANDREA
 1611 West Lakes Pkwy
 West Des Moines, IA 50266

500 Providence Twp Eldora-New Providence

500 Providence Twp Eldora-New Providence

Hardin County Tax Bill for September 2020 and March 2021. Please keep in a safe place. Send the correct stubs along with your check for payment. If your taxes are paid by your Bank in Escrow, this is for your information only. SEE REVERSE SIDE. Based on January 1, 2019 Valuations. Taxes cover the period from July 1, 2019 to June 30, 2020. Payable September 2020 and March 2021.

Parcel #: 000862005400002 Location:

500 Providence Twp Eldora-New Providence

Gross Acres -
 Exempt Acres -
 Net Acres -

LEGAL Description: NE SE

VALUATIONS AND TAXES THIS YEAR			LAST YEAR		TAX DUE	Delinquent Tax, Specials, Drainage, Tax Sale
A	Assessed	Taxable	Assessed	Taxable		
Land:	58,250	47,464	84,420	47,387		
Buildings:	-	-	-	-		
Dwelling:	-	-	-	-		
TOTAL VALUE:	58,250	47,464	84,420	47,387		
Less Military Exemption:						
NET TAXABLE VALUE:		\$47,464		\$47,387		
Value Times Levy per 1000 of:	27.6941200		26.3684400		004472000	
EQUALS GROSS TAX OF:		1,314.47		1,249.52		
Less Credits of:						BROWN, PAUL & ANDREA
Homestead Credit:						1611 West Lakes Pkwy
Ag Land Credit:		-49.17				West Des Moines, IA 50266
Family Farm Credit:		-34.49				
Business Prop Tax Credit Fund:						
Low Income/Elderly Credit:						
Prepaid Tax:						
NET ANNUAL TAXES:		\$1,230.00		\$1,250.00		

YOU MAY PAY ONLINE AT: WWW.IOWATREASURERS.ORG

Machel Eichmeier Hardin County Treasurer P.O. Box 391 Eldora, IA 50627 meichmeier@hardincountyia.gov	Receipt# 195737	DUE Sept. 1, 2020	\$633.00	DUE March 1, 2021	\$597.00
	Date Paid:	_____	_____	Date Paid:	_____
	CHECK#	_____	_____	CHECK#	_____

Gehrke Inc.

P.O. Box 228 • 1405 21st Avenue
Eldora, Iowa 50627
641-858-3821 • Fax 641-858-2564

10/08/20

TO: Hardin Co Supervisors

RE: Hardin Co Home Farm

We are pleased to submit the attached estimate.

Estimated total will not be more than \$2500.00.

Estimate includes:

Investigate issues with waterway tile and terrace erosion.

Note: After investigation Gehrke Inc will be able to prepose a plan and cost to repair issues.

If you have any questions regarding this estimate, please feel free to call our office at 641-858-3821. Thank you for the opportunity to bid this project.

Sincerely,



Jeremy Maas
Gehrke Inc.

County Auditor's Report of Fees Collected

State of IOWA) SS:
County of) Hardin County

To the Board of Supervisors of HARDIN COUNTY:

I, Jessica Lara, Auditor of the above named County and State, do hereby certify that the following is a true and correct statement of the fees collected by me in my office for the period of 9/1/2020 through 9/30/2020 and the same has been paid to the County Treasurer:

	No. Doc.	Fees collected
4150 Passport fees	0	\$0.00
4150 Photo fees	10	\$150.00
Total		\$150.00

All of which is respectfully submitted.

Jessica Lara
Hardin County Auditor

Date

Chairperson, Board of Supervisors

Date

Recorder's Monthly Report to the Treasurer

09/01/2020 to 09/30/2020

Liability

Account Number	Description	Net
0001-1-07-8000-400000-3	State Sales Tax-DOR	(\$1,491.00)
0001-1-07-8000-400000-4	Local Option Tax-DOR	(\$248.50)
0001-1-07-8000-401000-1	Snowmobile Registration Fees-State	(\$114.00)
0001-1-07-8000-401001	Snowmobile Titles - State	(\$13.00)
0001-1-07-8000-402000	RVVRS Boat Registration Fees - State	(\$337.15)
0001-1-07-8000-402001-1	RVVRS Boat Titles - State	(\$6.00)
0001-1-07-8000-402001-2	RVVRS Boat Titles - DOR	(\$20.00)
0001-1-07-8000-403000-1	Hunting & Fishing Fees-State	(\$806.00)
0001-1-07-8000-404000-2	Real Estate Transfer Tax-State	(\$15,741.08)
0001-1-07-8000-406000-1	Vitals Certified Copies-State	(\$1,033.00)
0001-1-07-8000-407000-1	ATV Registration Fees-State	(\$461.50)
0001-1-07-8000-407000-2	ATV Titles-State	(\$78.00)
0001-1-07-8000-407000-3	ATV Liens-State	(\$13.00)
0001-1-07-8000-413001-1	Marriage License-State	(\$217.00)
Total		(\$20,579.23)

Revenue

Account Number	Description	Net
0001-1-07-8000-400000	Recording of Instruments	(\$7,040.00)
0001-1-07-8000-400000-1	Over Payment	(\$40.00)
0001-1-07-8000-401000	Snowmobile Writing Fees (\$5.00)-County	(\$10.00)
0001-1-07-8000-402001	RVVRS Boat Titles - County	(\$20.00)
0001-1-07-8000-403000	Hunting & Fishing Fees-County	(\$25.50)
0001-1-07-8000-404000	Real Estate Transfer Tax-County	(\$3,281.32)
0001-1-07-8000-406000	Vitals Certified Copies-County	(\$372.00)
0001-1-07-8000-407000	ATV Writing Fees(\$5.00)-County	(\$70.00)
0001-1-07-8000-408000	RVVRS Writing Fees - County	(\$68.75)
0001-1-07-8000-410000	Auditor's Transfer Fees - \$5.00	(\$735.00)
0001-1-07-8000-413001	Marriage License-County	(\$28.00)
0001-1-07-8000-550000	Photocopy/Fax Fees	(\$223.15)
0024-1-07-0000-414000	Document Management Fees	(\$343.00)
5410-1-07-0000-416000	Electronic Transaction Fees	(\$343.00)
Total		\$12,599.72 ← (\$12,599.72)

Grand Total

~~(\$33,179.30)~~

\$33,178.95

* Per Verification from Taylor Johnson of Bowman and Miller. P.C. -
 Reduced Photocopy/Fax Fees by .35¢ to correct surcharge fee
 from credit card made in July 2020.

Cheryl Lawrence

Recorder's Monthly Report to the Treasurer

09/01/2020 to 09/30/2020

Range Summary

Range	Account	Net
Department of Revenue		
	0001-1-07-8000-400000-4 Local Option Tax-DOR	(\$248.50)
	0001-1-07-8000-400000-3 State Sales Tax-DOR	(\$1,491.00)
	0001-1-07-8000-402001-2 RVVRS Boat Titles - DOR	(\$20.00)
	0001-1-07-8000-404000-2 Real Estate Transfer Tax-State	(\$15,741.08)
Department of Revenue		(\$17,500.58)
Hunting and Fishing		
	0001-1-07-8000-403000 Hunting & Fishing Fees-County	(\$25.50)
	0001-1-07-8000-403000-1 Hunting & Fishing Fees-State	(\$806.00)
Hunting and Fishing		(\$831.50)
Marriage Application		
	0001-1-07-8000-413001-1 Marriage License-State	(\$217.00)
	0001-1-07-8000-413001 Marriage License-County	(\$28.00)
Marriage Application		(\$245.00)
RVVRS County		
	0001-1-07-8000-408000 RVVRS Writing Fees - County	(\$68.75)
	0001-1-07-8000-401000 Snowmobile Writing Fees (\$5.00)-County	(\$10.00)
	0001-1-07-8000-402001 RVVRS Boat Titles - County	(\$20.00)
	0001-1-07-8000-407000 ATV Writing Fees(\$5.00)-County	(\$70.00)
RVVRS County		(\$168.75)
RVVRS State		
	0001-1-07-8000-401001 Snowmobile Titles - State	(\$13.00)
	0001-1-07-8000-402000 RVVRS Boat Registration Fees - State	(\$337.15)
	0001-1-07-8000-402001-1 RVVRS Boat Titles - State	(\$6.00)
	0001-1-07-8000-407000-2 ATV Titles-State	(\$78.00)
	0001-1-07-8000-407000-1 ATV Registration Fees-State	(\$461.50)
	0001-1-07-8000-401000-1 Snowmobile Registration Fees-State	(\$114.00)
	0001-1-07-8000-407000-3 ATV Liens-State	(\$13.00)
RVVRS State		(\$1,022.65)
Transfer Tax		
	0001-1-07-8000-404000 Real Estate Transfer Tax-County	(\$3,281.32)
	0001-1-07-8000-404000-2 Real Estate Transfer Tax-State	(\$15,741.08)
Transfer Tax		(\$19,022.40)
Vitals Certified Copies		
	0001-1-07-8000-406000-1 Vitals Certified Copies-State	(\$1,033.00)
	0001-1-07-8000-406000 Vitals Certified Copies-County	(\$372.00)
Vitals Certified Copies		(\$1,405.00)

HARDIN CO. SHERIFF'S OFFICE



A New Century of Service

David L. McDaniel
116 14th Avenue
Idora, Iowa 50627
41-939-8189
-800-568-4373
Fax 641-939-8249

20-21 Fiscal Year

0001-1-05-1000-440003
0001-1-05-1000-440004
0001-1-05-9000-440001

September fees

Civil Fees	\$ 2,685.62
Civil Mileage	\$ 598.88
Mental Transports	\$ -
Total:	\$ 3,284.50

20-21 Fiscal Year

0001-1-05-1000-250100
0001-1-05-1000-250200
0001-1-05-9000-440002
0001-1-05-1000-440006
0001-1-05-1000-441000
0001-1-05-1000-443000
0001-1-05-1000-445000
0001-1-05-1000-550001
0001-1-05-1000-850100
0001-1-05-1000-440007
0001-4-05-1000-849000

September fees

Contract Law	\$ 16,118.75
Care Prisoners	\$ 131,377.28
Driving Records	\$ 6.50
Purchase Permits	\$ -
Weapon Permits	\$ 1,540.00
Work Release	\$ -
Sex Offender Reg.	\$ 50.00
Copy Reports	\$ 86.50
CO ENF Surcharge	\$ 185.00
Fingerprint fees	\$ 100.00
Miscellaneous	\$ -
Total:	\$ 149,464.03

Funds paid to Treasurer
on 9/30/2020

Total fees
FY 20/21
\$ 152,748.53

POLICY FOR PUBLIC ENTERING COUNTY COURTHOUSE, COUNTY OFFICE BUILDING, COUNTY JAIL/SHERIFF OFFICE

1. The County shall set threshold temperature based on IDPH or local BOH guidelines.
2. The County shall require all that enter the courthouse, county office building or jail/sheriff building to check temperature each time the person enters.
3. The County shall refuse entry to anyone that exceeds temperature threshold as indicated by the device.
4. The County shall issue a fact sheet to anyone that has been refused entry. Fact sheet will contain a disclaimer that this is not a medical diagnosis, as well as IDPH information and Hardin County office and Clerk of Court phone numbers.
5. Any person denied entry that elects to have a second temperature check will have to exit the vestibule by a safe distance during the waiting period. Anyone refused entry can re-try once within 10 minutes of refused entry.
6. Security will log the refusal as a “no show”. Departments will indicate the refusal as either a “no show” or “had to reschedule” which ever applies.
7. The County shall make no written record of a specific person’s specific temperature.
8. The County shall make no health declaration about any person allowed entry or refused entry.
9. It will be the department’s discretion whether or not to serve anyone refused entry, but if service is provided, it shall be outside the county-owned building and both county employee and member of the public must wear approved face mask.
10. **Courthouse security will request the following information from the public before entry: Name, Destination within the Courthouse, Phone Number. Per Iowa Department of Public Health guidelines, entry will be denied for failing to provide name and destination within the courthouse. Entry will NOT be denied for failing to provide a phone number. A phone number is requested for the public convenience (to notify the individual when they may enter) and for public health (COVID contact tracing).**

EMPLOYEE ENTRY POLICY

1. The County shall set threshold temperature based on IDPH or local BOH guidelines.
2. All employees entering either the courthouse, county office building, or jail facility for the first time on any given day must pass the temperature check.
3. Subsequent entries on the same day will not require re-check.
4. Refuse entry to any employee that exceeds temperature threshold.
5. Anyone refused entry can re-try once within 10 minutes of refused entry.
6. Issue fact sheet to anyone that has been refused entry. Fact sheet will contain IDPH information and Hardin County office phone numbers. All employees must contact their respective supervisor immediately.
7. Make no written record of a specific person’s specific temperature.
8. Make no health declaration about any person allowed entry or refused entry.